

COMMUNITY PRESENTATION
JUNE 2023



PROVIDENCE

Reimagined

PROVIDENCEREIMAGINED.COM

*Information, plans, imagery and renderings are subject to change, for illustrative purposes only, and should not be relied upon as definitive. References to "EYA" refer to EYA, LLC. EYA, LLC's development affiliates build homes in the Virginia, Maryland, and Washington, DC metropolitan area. Individual projects are developed and sold by EYA-affiliated entities, and all representations regarding the development, construction, or sale of any project or property refers to those affiliates. For PROVIDENCE REIMAGINED, the development affiliate entity is **VISION PH ASSOCIATES LLC**. No representations regarding the development, construction or sale of any portion of this community is made by EYA LLC or any EYA affiliate except **VISION PH ASSOCIATES LLC**.*

ABOUT EYA

- Award-winning local residential builder in DC, MD, and VA for 30 years
- Nearly 50 communities and 6,000 homes
- Focused on creating communities convenient to transit, retail, and recreational amenities

- | | | |
|--------------------------------------|---|---------------------------------|
| 1. Stonegate | 21. Chatham Square | 40. Tower Oaks |
| 2. Rivergate | 22. Potomac Greens | 41. Cabin John Village |
| 3. Palisades Park | 23. Park Potomac | 42. The Towns at Reston Station |
| 4. Courthouse Hill | 24. Centerpointe | 43. Riggs Park Place |
| 5. Hillandale | 25. National Park Seminary | 44. Michigan Park |
| 6. Ford's Landing | 26. Arts District Hyattsville | 45. Graham Park |
| 7. Old Town Village | 27. Capitol Quarter | 46. Sutton Heights |
| 8. Courts of Chevy Chase | 28. Alexandria Crossing | 47. Tysons Ridge |
| 9. Westwood Village | 29. Chancellor's Row | 48. Farmstead District |
| 10. Monument Place | 30. Old Town Commons | |
| 11. Cameron Hill | 31. Mosaic District | |
| 12. Capitol Square | 32. The Oronoco | |
| 13. Harrison Square | 33. Little Falls Place | |
| 14. Carlyle City Residences | 34. Chelsea Heights | |
| 15. Clarendon Park | 35. Westside at Shady Grove Metro | |
| 16. Fallsgrove | 36. Grosvenor Heights | |
| 17. The Lofts at Braddock Metro | 37. Montgomery Row at Rock Spring | |
| 18. Strathmore Park | 38. The Brownstones at Chevy Chase Lake | |
| 19. Bryan Square | 39. Robinson Landing | |
| 20. The Brownstones at Wheaton Metro | | |

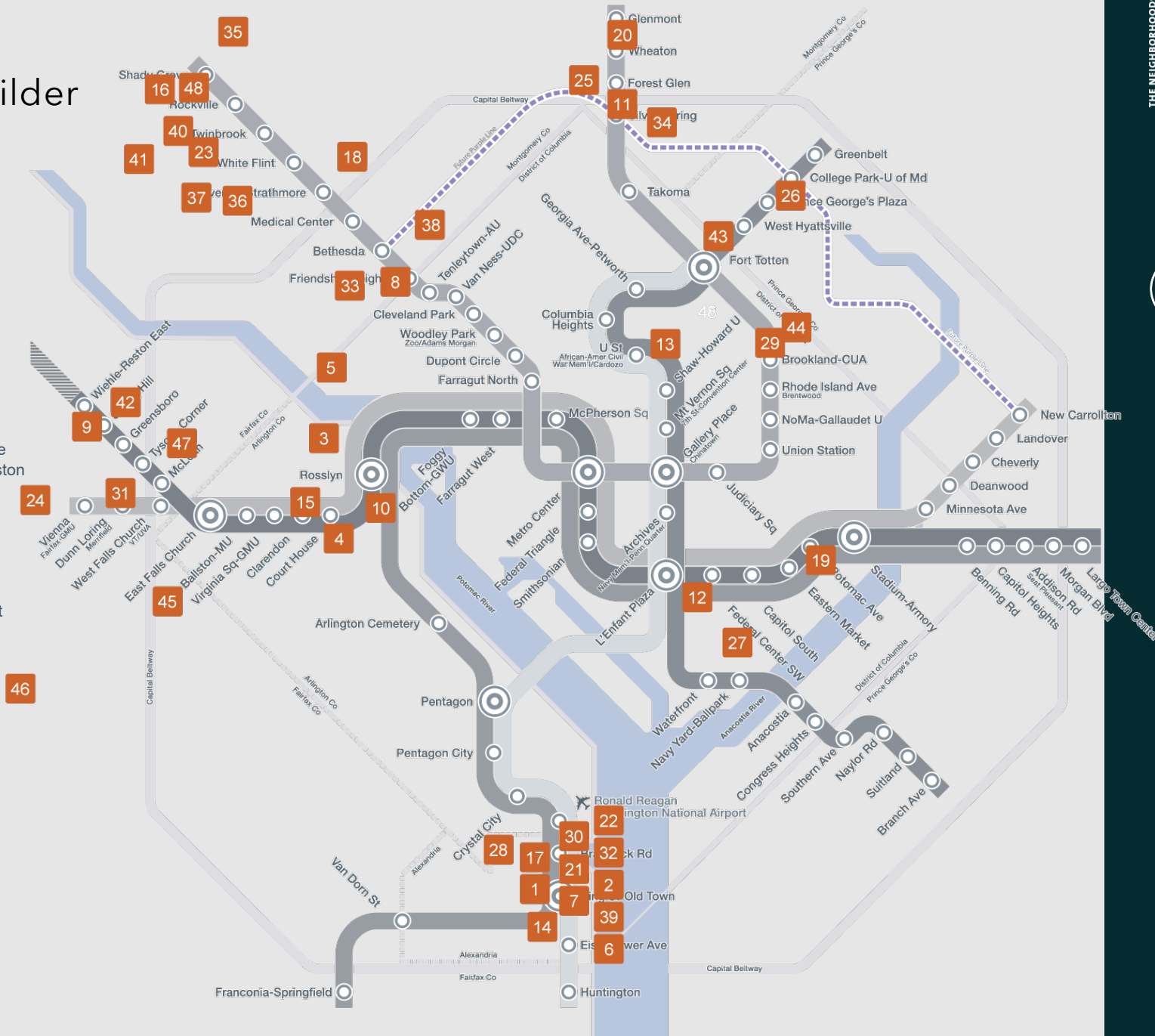

THE MENKITI GROUP

ABOUT US

Founded in 2004, The Menkiti Group is a 100% minority-owned Certified Business Enterprise headquartered in Washington, DC, with additional offices in Worcester, Massachusetts.

An integrated real estate services company, The Menkiti Group focuses on a double bottom line, measuring success in terms of positive social impact and financial returns. The company was founded with the mission to transform lives, careers, and communities through real estate, and is committed to driving neighborhood impact and engaging in communities with a long-term lens. Focuses include urban investment, residential and commercial development, residential sales, and commercial brokerage.

The company's approach to urban neighborhood transformation and investment is centered upon partnerships with capital investors, local developers, community stakeholders, and small business owners to create thriving urban spaces that drive sustainable neighborhood impact and produce economic growth. Projects range from residential renovations and the development and tenancing of main street commercial properties to large-scale, mixed-use, transit-oriented development projects.

To date, The Menkiti Group has invested over \$360MM in emerging urban neighborhoods, worked on the development of over 3.8MM SF of real estate, and assisted over 2,000 families in purchasing their first homes. Their CPMG Foundation has supported over 41,000 families since its inception in 2014 and invests in organizations making an impact in education, housing, youth and entrepreneurship.

VISION

We envision an America where all communities are thriving, diverse, and economically vibrant habitats.

MISSION

To transform lives, careers and communities through real estate.

PORTFOLIO

The Menkiti Group currently has over 4.9MM SF in its development pipeline including catalytic projects such as MLK Gateway in Anacostia, Bond Bread with Howard University, The Yards Parcels G1 and G2 in partnership with Brookfield, and St. Elizabeths Parcels 7, 8, and 9.

19
YRS
IN
BUSINESS

\$360
MM
INVESTED IN
NEIGHBORHOODS

3.8MM
SF
DEVELOPMENT
WORKED ON

4.9MM
SF
DEVELOPMENT
IN THE PIPELINE



3401 8th Street NE,
Washington, DC 20017
www.menkitigroup.com

554 Main Street
Worcester, MA 01608
www.mgworchester.com

202.733.5455
info@menkitigroup.com
[@themenkitigroup](https://www.instagram.com/themenkitigroup)

CURRENT CONTEXT

- Providence Urgent Care, Diagnostic Imaging and Pharmacy closed on July 31, 2023. The Providence physician practices remain open and continue to serve the community.



EXISTING BUILDINGS TO REMAIN POST REDEVELOPMENT

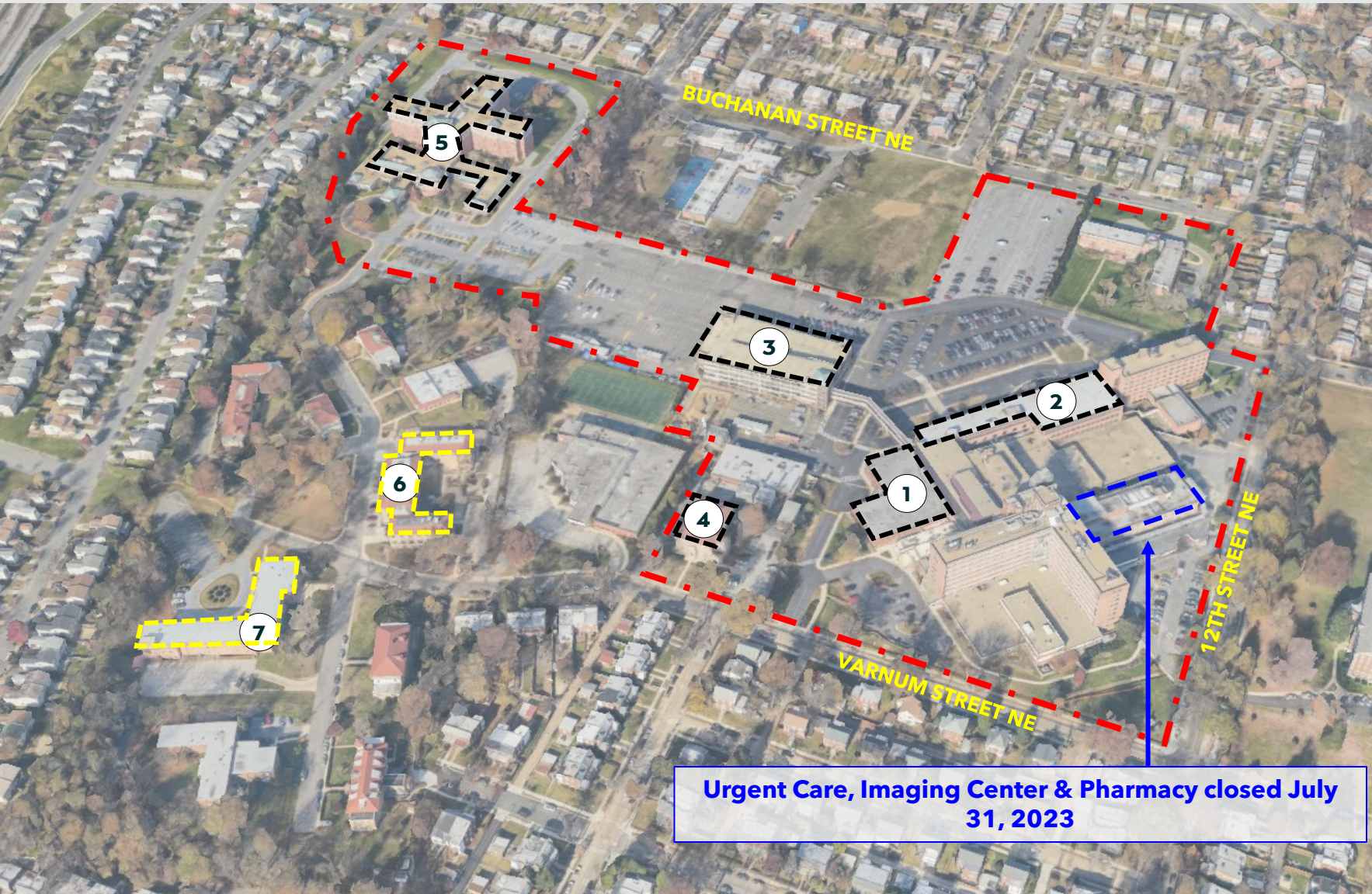

Urgent Care, Imaging Center & Pharmacy closed July 31, 2023

ON CAMPUS:

- 1: Providence Med Bldg
32K SF, 3 floors
- 2: DePaul Med Bldg
69.5K SF, 4 floors
- 3: Parking Garage
405 spaces, 5 floors
- 4: Police & Fire Clinic
15K SF, 3 floors
- 5: Carroll Manor Nursing
169K SF, 6 floors

OFF CAMPUS:

- 6: Existing Mundo Verde
- 7: Mundo Verde
Addition

MISSION BASED FOCUS AREAS

EDUCATION AND NON-PROFITS



SENIOR CARE



MIXED-INCOME HOUSING



PARKS AND OPEN SPACE



VISION

Transform a vacant hospital and acres of asphalt parking lots into an **appropriately-scaled mixed-income and mixed-use neighborhood.**

Respect the existing residential context and create open space and parks that will become the **central gathering place for the community.**



EDUCATION AND NON-PROFIT USES

EDUCATION AND NON-PROFIT USES

- Mundo Verde addition at 817 Varnum Street NE
- Police and fire occupational therapy clinic
- Carroll Manor Nursing Home
- Medical office buildings at 1140 & 1160 Varnum Street NE to remain



EXISTING MEDICAL USES ON CAMPUS

EXISTING TO REMAIN POST REDEVELOPMENT:

- Dental
- Allergy and Immunology (multiple)
- Nephrology (kidney) (multiple)
- Washington Eye Specialists
- Family Nurse Practitioner
- Infectious Disease (multiple)
- Cardiology (multiple)
- Endocrinology
- Internal Medicine (multiple)
- Family Medicine (multiple)
- Foot & Ankle Associates of DC
- Neurology (multiple)
- Diabetic Eye and Macular Disease Specialists
- Gastroenterology
- Center for Vein Restoration
- Pulmonary Critical Care
- Pain Management (multiple)
- Physical Therapy
- OB/GYN
- Speech Therapy
- Hematology & Oncology
- ENT
- LabCorp
- **Convenient Clinic Urgent Care & Primary Care**

An inviting redeveloped
campus is key to retaining
and attracting great medical
uses long term

SENIOR CARE

SENIOR CARE

- Carroll Manor Nursing Home
- New senior affordable housing building
- Many key medical practices targeted towards seniors to remain on site.
- Open space
 - Fitness and recreation focused
 - Healthy walking loop for exercise



HOUSING

DC HOUSING CRISIS

- DC median townhome price has grown 1.5x since 2013
- Wash Post: Brookland/Michigan Park: **15.1%** increase in average sales price in 2021 to **\$745,000**

DC & DC Metro Townhome Median Sale Prices Over Time

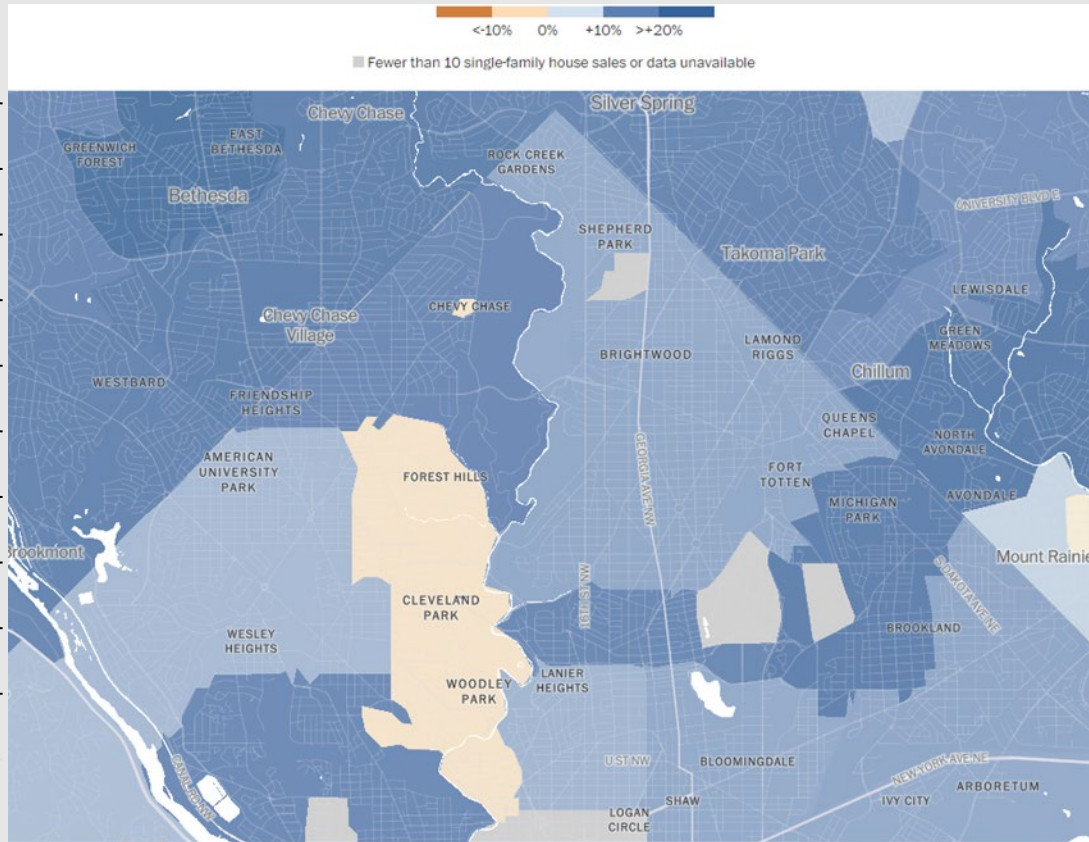
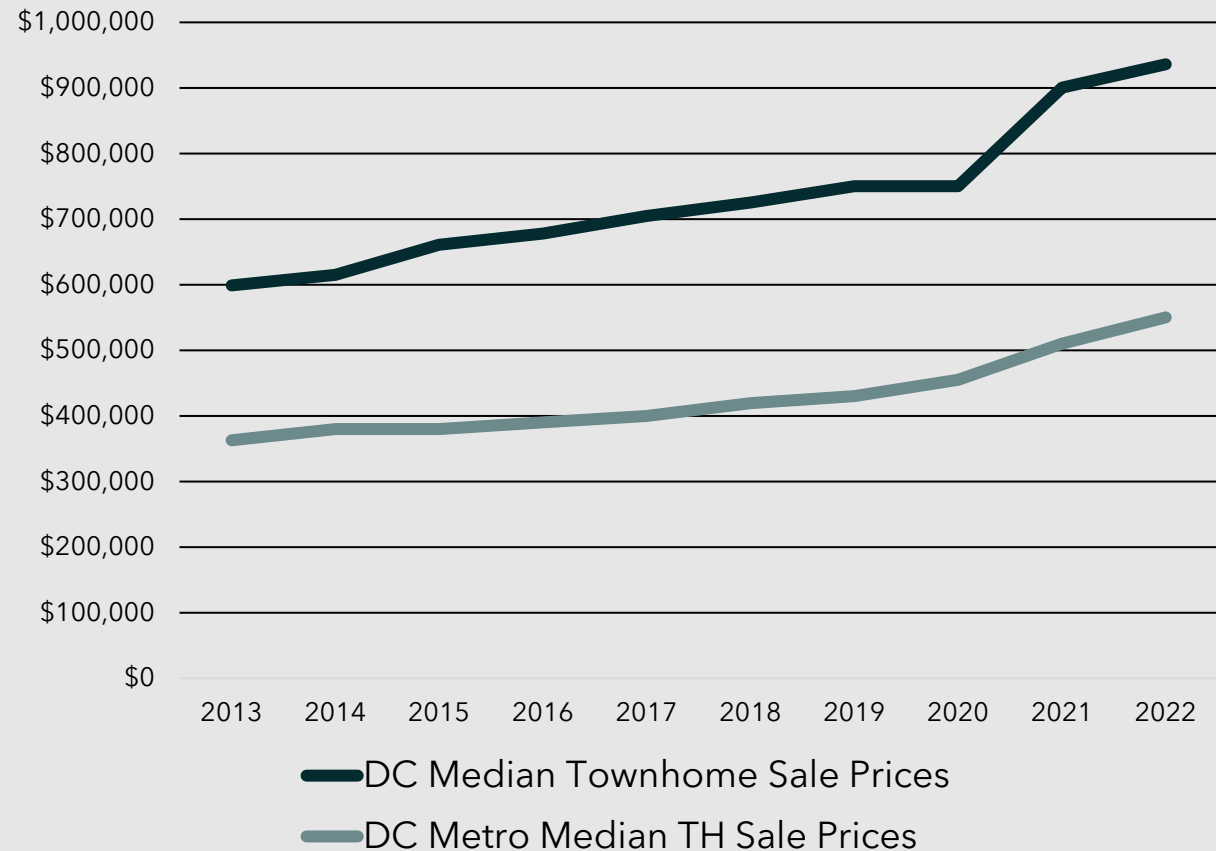

LOCAL SOLUTION TO THE HOUSING CRISIS

Existing Neighborhood*: 0% protected affordable

- Kennedy & Josephite's developments will make 2% of neighborhood housing stock protected affordable

Base Providence Proposal: 20% of new housing to be protected affordable; aiming for 30%.

- Approximately 150 new affordable homes relative to the 772 existing.
- **For every 4-6 existing homes, there will be 1 new protected affordable home built.**
- Neighborhood will be ~15% protected affordable overall in line with DC goals.
- Provides affordable housing opportunities in the neighborhood for seniors and renters to ensure socioeconomic diversity over the long-term and enable existing homeowners to build equity in their homes.

**Neighborhood here is defined as ANC Single Member District 5A03*

WHO LIVES IN AFFORDABLE/WORKFORCE HOUSING

	PROFESSIONAL	AMI	INDIVIDUAL INCOME	HOUSEHOLD INCOME (4 PPL)
POLICE OFFICER		80%	\$ 59,875	\$113,850
PUBLIC SCHOOL TEACHER		80%	\$ 68,453	
FIRE FIGHTER		60%	\$ 50,871	\$85,400
NURSE (LPN)		60%	\$ 52,658	
EMT		50%	\$ 39,093	\$71,150
DELIVERY TRUCK DRIVER		50%	\$ 43,626	
STOCK CLERK		50%	\$ 39,455	
CASHIER		30%	\$ 25,306	\$42,700
BARTENDER		30%	\$ 25,773	

Source: Menkiti; National Housing Conference

PARKS, OPEN SPACES AND PLACEMAKING

MULTI-PURPOSE SPORTS FIELD & HARDSCAPE PLAY AREA



Information, plans, imagery and renderings are subject to change, for illustrative purposes only, and should not be relied upon as definitive.

THE NEIGHBORHOODS OF
EYA

MENKITI
GROUP



ProvidenceReimagined.com

EXERCISE LOOP AND PLAYGROUND/CYCLE TRACK



Information, plans, imagery and renderings are subject to change, for illustrative purposes only, and should not be relied upon as definitive.

COMMUNITY GREEN, SEATING AREAS, & HERITAGE TREES



Information, plans, imagery and renderings are subject to change, for illustrative purposes only, and should not be relied upon as definitive.

SITE DIAGRAMS



EXISTING BUILDINGS TO REMAIN POST REDEVELOPMENT



ON CAMPUS:

- 1: Providence Med Bldg
32K SF, 3 floors
- 2: DePaul Med Bldg
69.5K SF, 4 floors
- 3: Parking Garage
405 spaces, 5 floors
- 4: Police & Fire Clinic
15K SF, 3 floors
- 5: Carroll Manor Nursing
169K SF, 6 floors

OFF CAMPUS:

- 6: Existing Mundo Verde
- 7: Mundo Verde
Addition

EXISTING CONDITIONS PLAN: BUILDINGS TO REMAIN

Existing Buildings
- To Remain

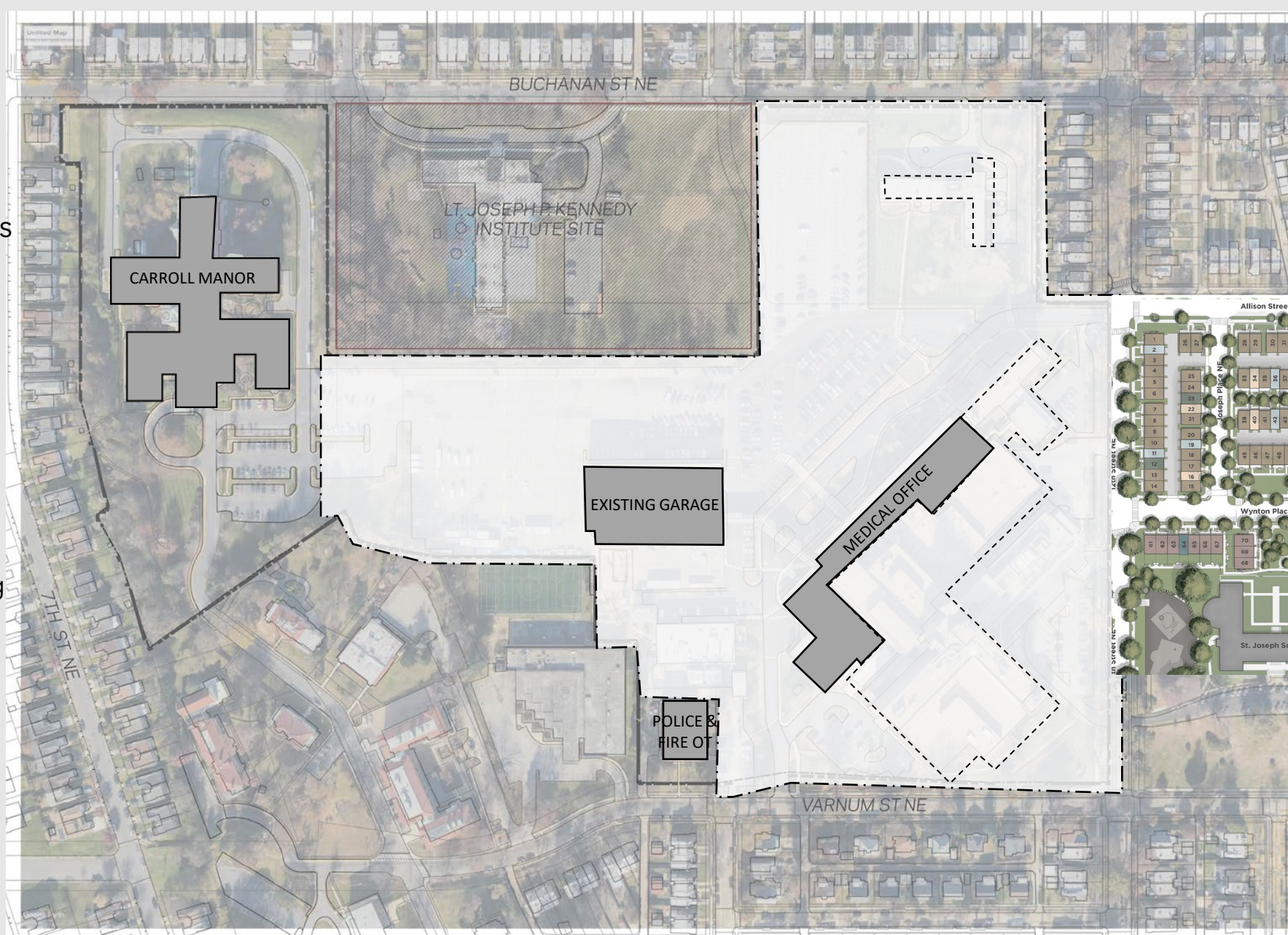

Site Constraints:

- Angle of existing buildings & parking to remain
- Kennedy School - 10th Street to the north
- Police & Fire building - 10th Street to the south
- Carroll Manor to the west



Information, plans, imagery and renderings are subject to change, for illustrative purposes only, and should not be relied upon as definitive.

GRID OF STREETS

-  Existing Buildings - To Remain
-  Street Grid/ New Roads

Grid of New Streets:

- North/South Connection
- Traffic Calming and Deflection
- Connection/entry to Carroll Manor
- Extension of Allison Street NE
- Drop-off Zone for MOB
- Avoid Police and Fire OT and Kennedy

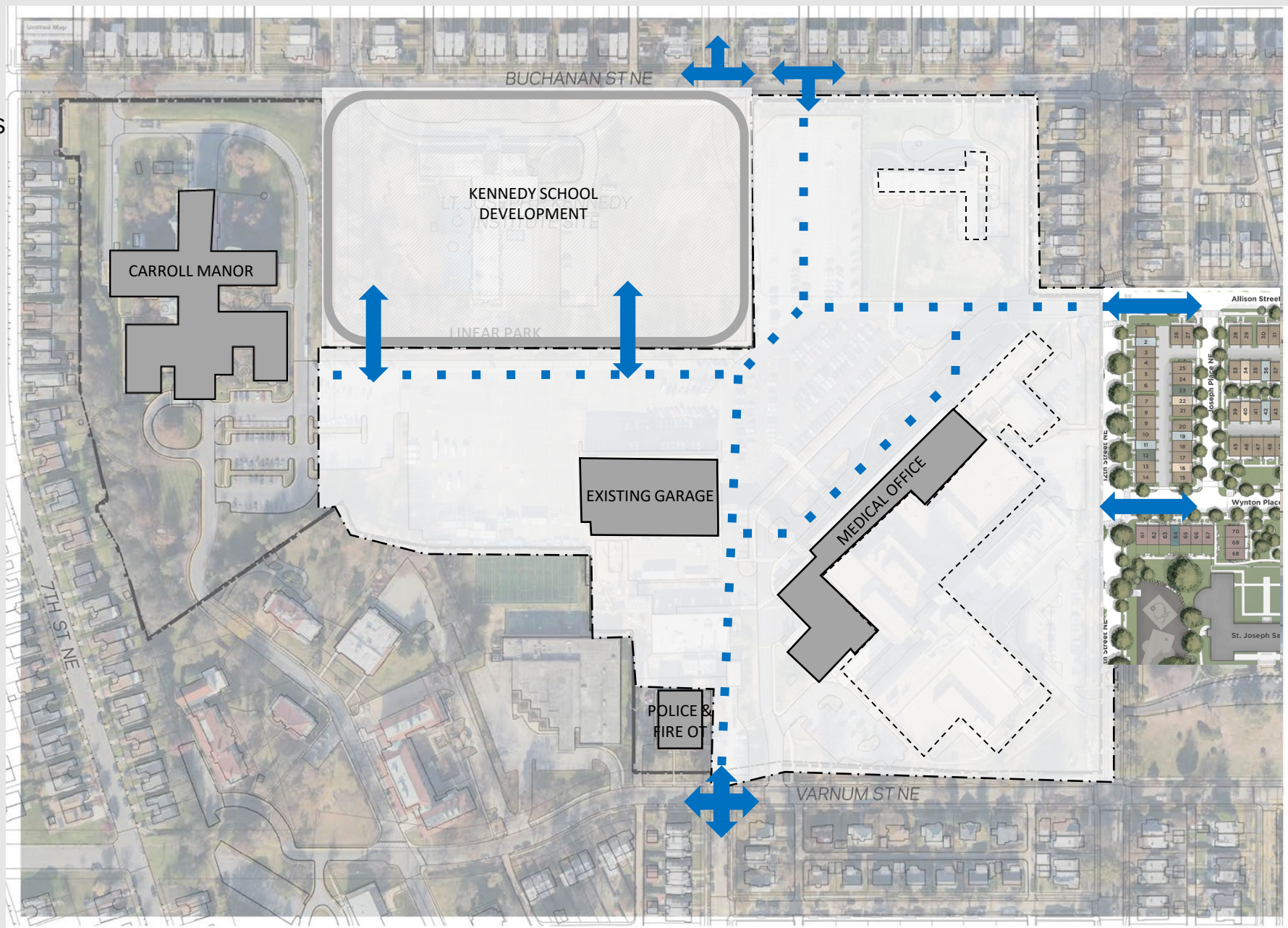



Information, plans, imagery and renderings are subject to change, for illustrative purposes only, and should not be relied upon as definitive.

POTENTIAL LARGE CENTRAL OPEN SPACE



Information, plans, imagery and renderings are subject to change, for illustrative purposes only, and should not be relied upon as definitive.

PARKS AND OPEN SPACES

-  Existing Buildings
– To Remain
-  Street Grid/
New Roads
-  Park/Open Space
Options

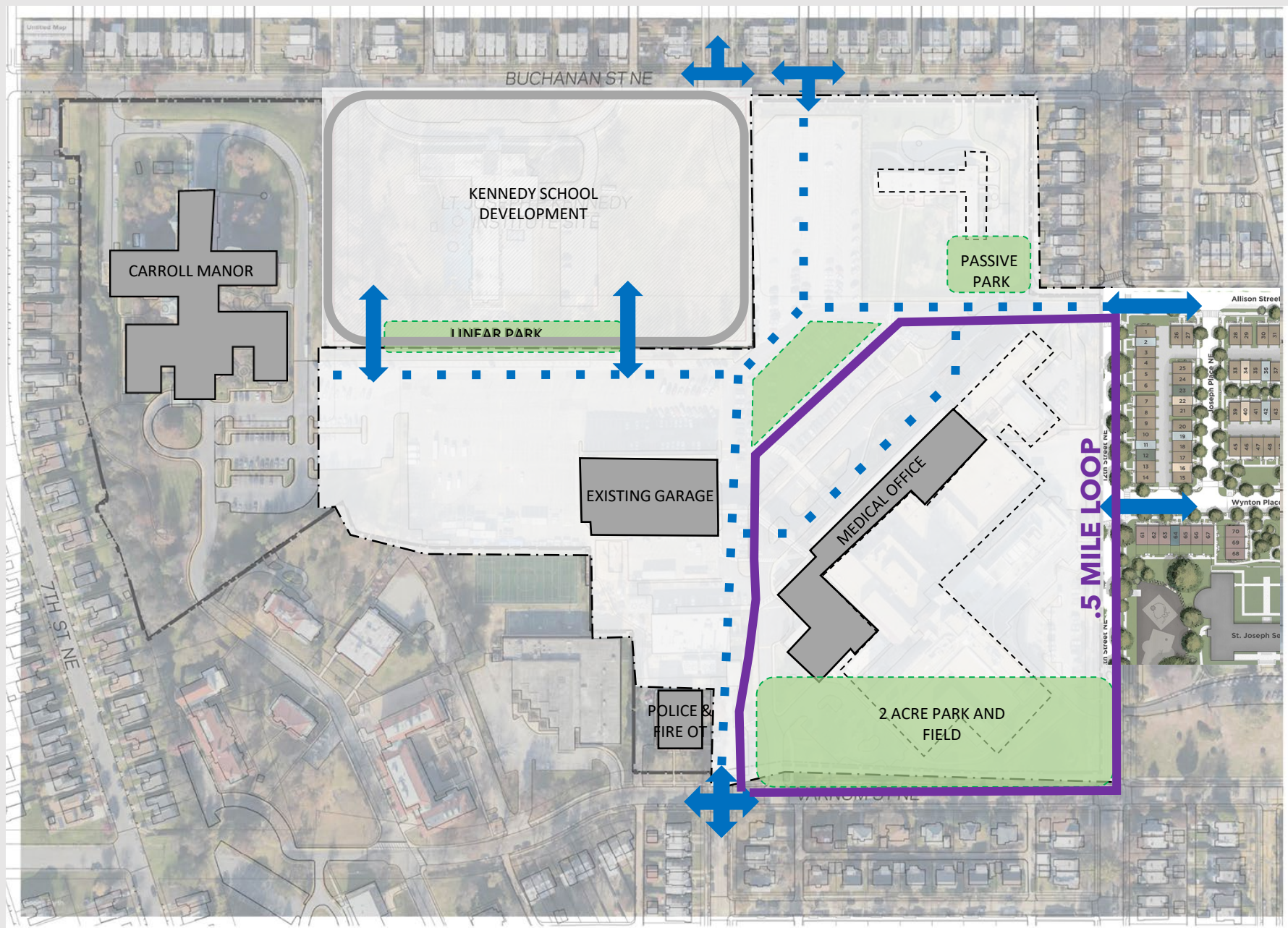

Information, plans, imagery and renderings are subject to change, for illustrative purposes only, and should not be relied upon as definitive.

SITE PLAN OPTION A



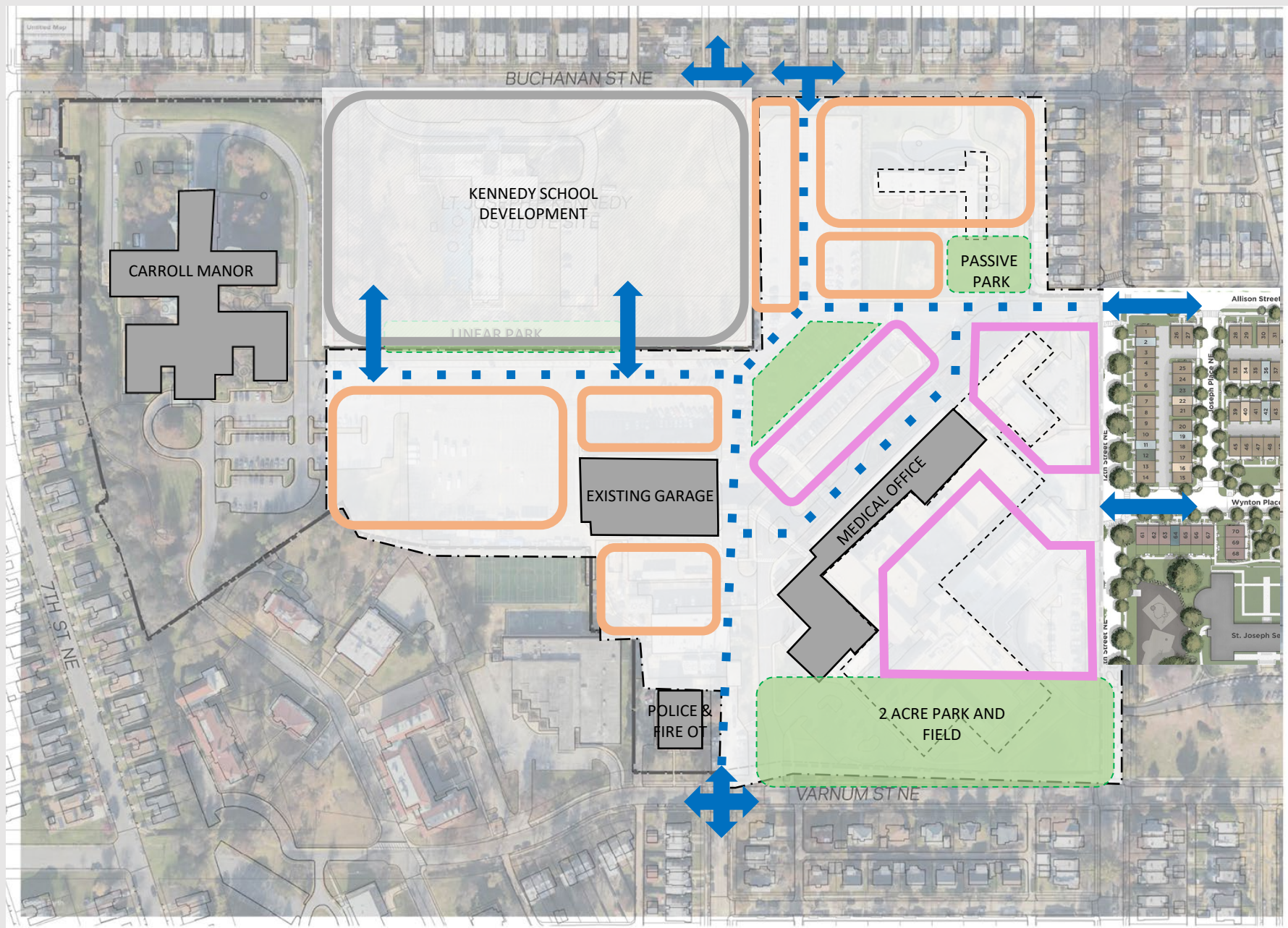

-  Existing Buildings
– To Remain
-  Street Grid/
New Roads
-  Park/Open Space
Options
-  Max 4 story zone
-  Max 6 story zone

NOTE:
Existing hospital
is 9 stories tall.



Information, plans, imagery and renderings are subject to change, for illustrative purposes only, and should not be relied upon as definitive.

SITE PLAN OPTION B

-  Existing Buildings
– To Remain
-  Street Grid/
New Roads
-  Park/Open Space
Options
-  Max 4 story zone
-  Max 6 story zone

NOTE:
Existing hospital
is 9 stories tall.

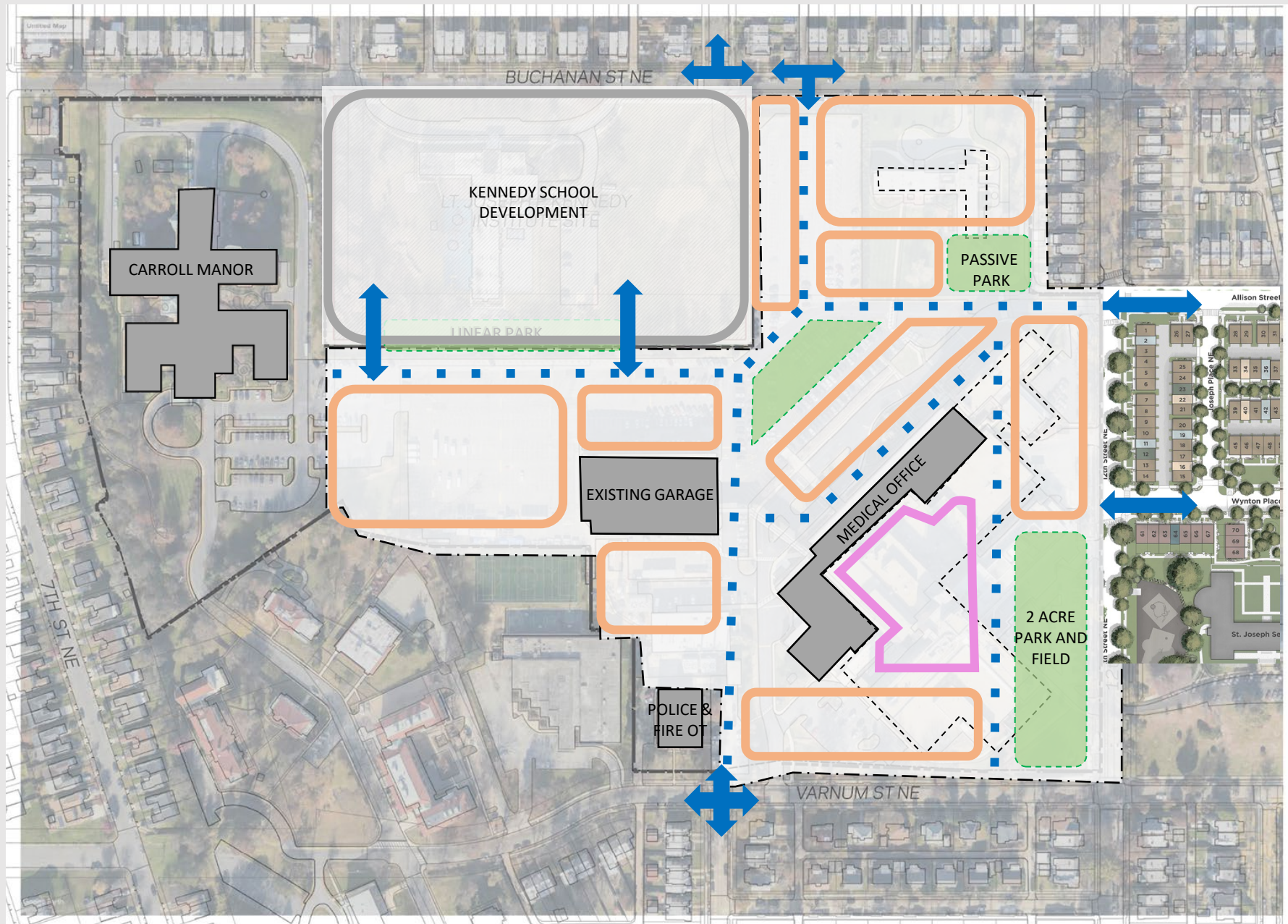

Information, plans, imagery and renderings are subject to change, for illustrative purposes only, and should not be relied upon as definitive.

SITE PLAN OPTION A

-  Existing Buildings
– To Remain
-  Street Grid/
New Roads
-  Max 4 story zone
-  Max 6 story zone

NOTE:
Existing hospital
is 9 stories tall.

Park/Open Space
Options:

- 1 Linear Park
- 2 Community Park/Plaza
- 3 Passive Park
- 4 Community Central
Park (2ac.)

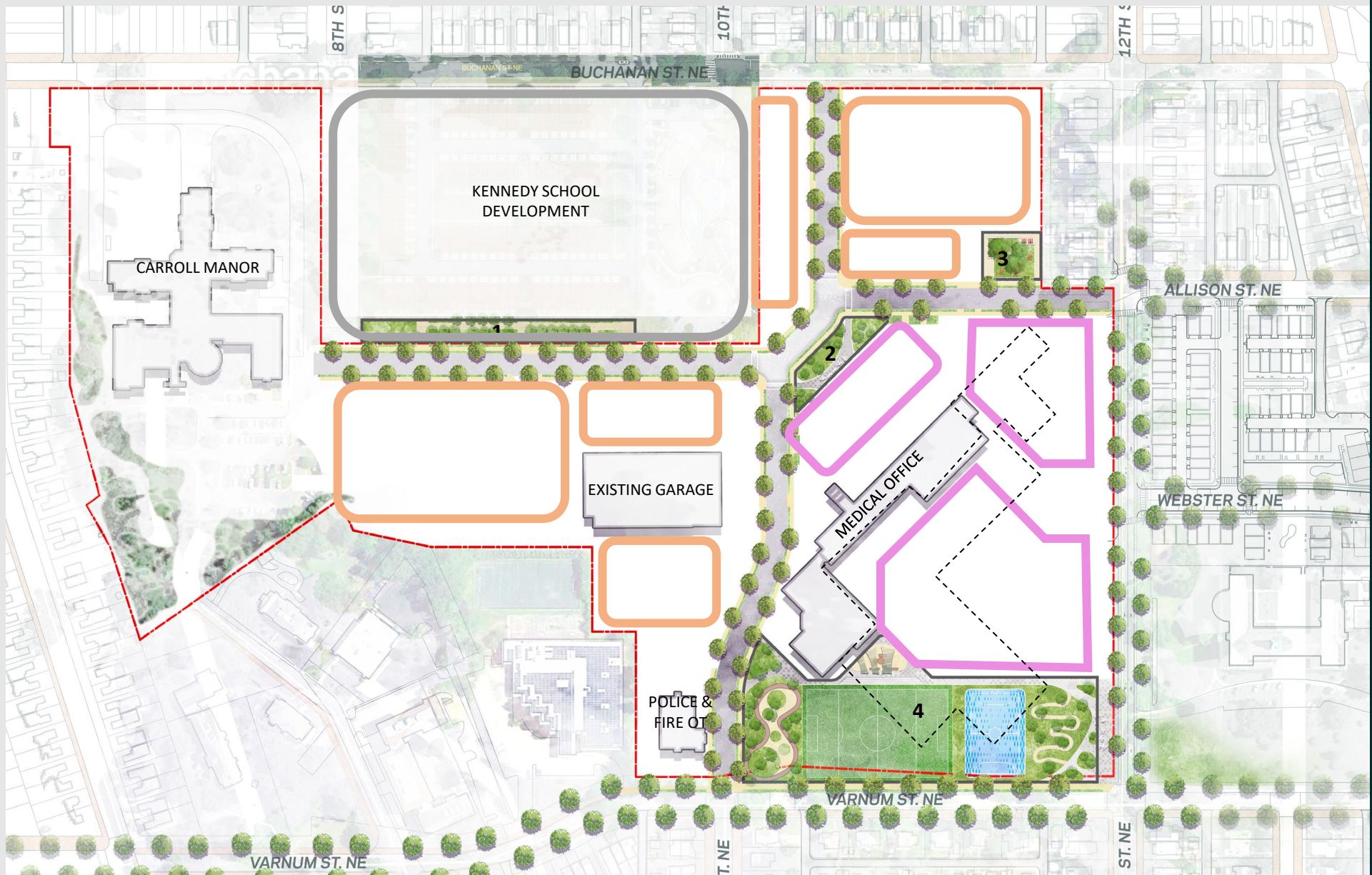

Information, plans, imagery and renderings are subject to change, for illustrative purposes only, and should not be relied upon as definitive.

CENTRAL COMMUNITY PARK CONCEPT



- | | | |
|-------------------------------------|---|---|
| 1 Entry Plaza | 4 Hardscape Court(s) | 7 Community Plaza |
| 2 Soccer Field (140' x 220') | 5 Community Garden Plots | 8 Streetscape Improvements/
Walk Loop |
| 3 Children Playground | 6 Native Garden/Sitting
Areas | |

Information, plans, imagery and renderings are subject to change, for illustrative purposes only, and should not be relied upon as definitive.

ZONING AND PROCESS



COMP PLAN AND ZONING (ENTITLEMENT)

Zoning:

- Comp Plan Recommendation: Institutional
- Zone RA-1 Permitted Uses:
 - Medical care including Urgent Care
 - Townhomes and apartments
 - Continuing care retirement community
 - Childcare center
- Retail (Café, grocer etc.) not allowed by-right but encouraged via Comprehensive Plan

Entitlement Process:

- Planned Unit Development ("PUD"), submitted by Applicant and approved by DC Zoning Commission.

Entitlement Timeline:

- PUD: 9 to 12 months
- Site Plan and Permits: 12 months
- Groundbreaking assuming no appeal: 21 to 24 months
- Construction timeline: 24 to 30 months

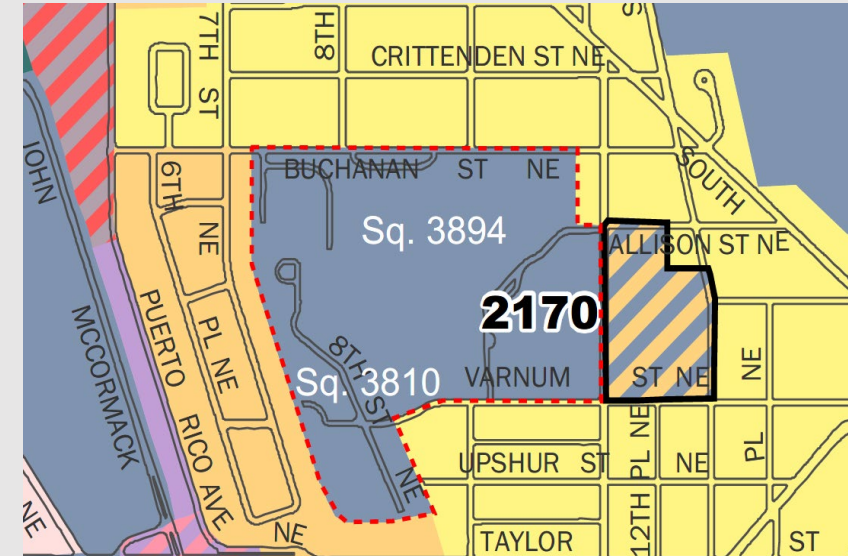

COMMITTED PROFFERS

- Multiple parks including space geared specifically to seniors and children
- At least 20% of new housing to be affordable
- Preservation of heritage trees & other key trees on site
- Additional streets with trees, sidewalks, and other pedestrian-friendly features on-site



Information, plans, imagery and renderings are subject to change, for illustrative purposes only, and should not be relied upon as definitive.

POTENTIAL PROFFERS

- Proactively engage local & minority-owned contractors & vendors during construction bid process to increase access to work for local contractors.
 - Publicize upcoming bid process early via local & minority-led business organizations
 - Host info sessions specifically for locally-based contractors during bid process
 - Give preference to locally-based/minority owned firms in final selections
- Engage local students in internships and other educational opportunities on-site
- Provide property tax relief fund for nearby existing residents
- Build up to 30% of new housing as affordable to those making <80% of AMI
- Host medical fair to showcase medical providers remaining on-site
- Host housing fair to showcase DC support for homeowners
 - (Property tax relief for seniors, public employee homebuyer programs etc.)
- Offer traffic calming features on adjacent streets
- Construction truck traffic management during building period
- Develop retail space tailored to a new urgent care provider on the newly developed site

FUTURE MEETINGS

To sign up to attend an upcoming meeting, review FAQs, and receive updates on the project, visit www.PROVIDENCEREIMAGINED.com

Reach the team at info@ProvidenceReimagined.com

Prior Meetings

- Thursday, May 4th at 6:45 PM ANC SMD 5A03 Meeting (Zoom)
- Monday, May 8th at 6:30 PM (Zoom)
- Monday, May 8th at 8:30 PM (Zoom)
- Wednesday, May 10th at 8 AM (Zoom)
- Friday, May 12th at 12 PM (Zoom)
- Monday, May 22nd at 7 PM (Zoom)
- ANC 5A Meeting - Thursday, May 25th at 6:45 PM (Zoom)
- Friday, May 26th at 12 PM (Zoom)
- Tuesday, May 30th at 8 PM (Zoom)
- Wednesday, May 31st at 12 PM (Zoom)
- Thursday, June 1st Meeting at 7 PM (Lamond Riggs Library)
- North Michigan Park Civic Assoc. - June 7th at 7 PM (1333 Emerson St. NE)
- Friday, June 9th at 12 PM (Zoom)
- Queens Chapel Civic Association - June 12th at 7 PM (1860 Michigan Ave. NE)
- Saturday, June 17th Morning Social (Michigan Park Community Playground)
- Brookland Neighborhood Civic Association - June 20th at 7:30 PM (Zoom)
- ANC 5B05 Meeting - June 26th at 7:30 PM (Zoom)

Other Upcoming Meetings

- Michigan Park Citizens Association - August 1, 2023
- Lamond-Riggs Citizens Association - Date & Time TBD

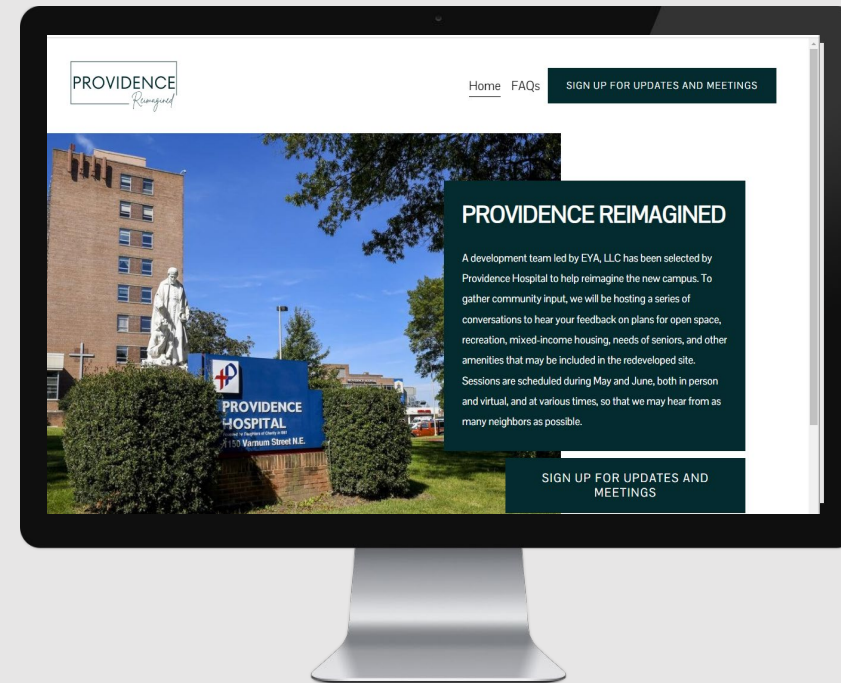

THANK YOU

Visit www.ProvidenceReimagined.com for more info.

Reach the team at Info@ProvidenceReimagined.com